

■ 16ch Multi Viewer

MV-162

Preliminary

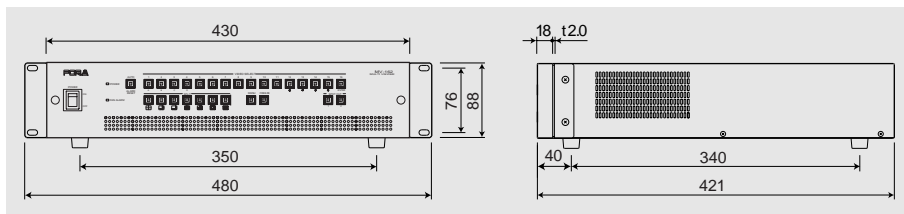
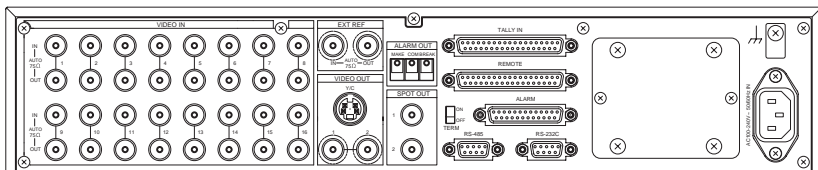

Standard	525/60 (NTSC) or 625/50 (PAL) (Auto Select)
Video Input	Composite, Color or B/W, 1.0Vp-p, 75Ω or loopthru, 16ea., BNC
Reference Input	Composite or BB., 1.0Vp-p, 75Ω or loopthru, 1ea., BNC
Video Output	Composite, 1.0Vp-p ±3dB, 75Ω, 2ea., BNC Y/C, Y: 1.0Vp-p ±3dB, C: 0.286(0.3)Vp-p ±3dB, 1ea., 4-pin S-connector
Display Modes	FULL, 4/9/16/5+1/7+1/12+1(2types)
Title	Camera title: 4character/1 line, all inputs. Icon: ALARM/FREEZE/LOSS Color Border: green or red Date: Year-Month-Day, Hours:Minutes:Seconds
Interface	RS-232C, RS-485, REMOTE, ALARM, TALLY
Temperature / Humidity	0°C - 40°C / 30% - 90% (no condensation)
Power	AC100V - 240V, 50/60Hz
Dimensions	424(W) x 88(H) x 350(D)mm, EIA2RU

The MV-162 is a low-priced 16-split Multi Viewer with numerous functions. Seven split-screen setting patterns can be created by combining different image sizes.

- Accepts 16 asynchronous composite images (color and B/W can be mixed) as inputs.
- Loop-through on all channels for easy system expansion.
- In addition to 4-, 9-, and 16-split screens, the MV-162 can display various other splits, such as 5+1, 7+1, and 12+1 (2 types).
- Time stamp (year, month, date, hours, minutes, seconds) information can be superimposed.

